

REV	REVISION	NAME	DATE

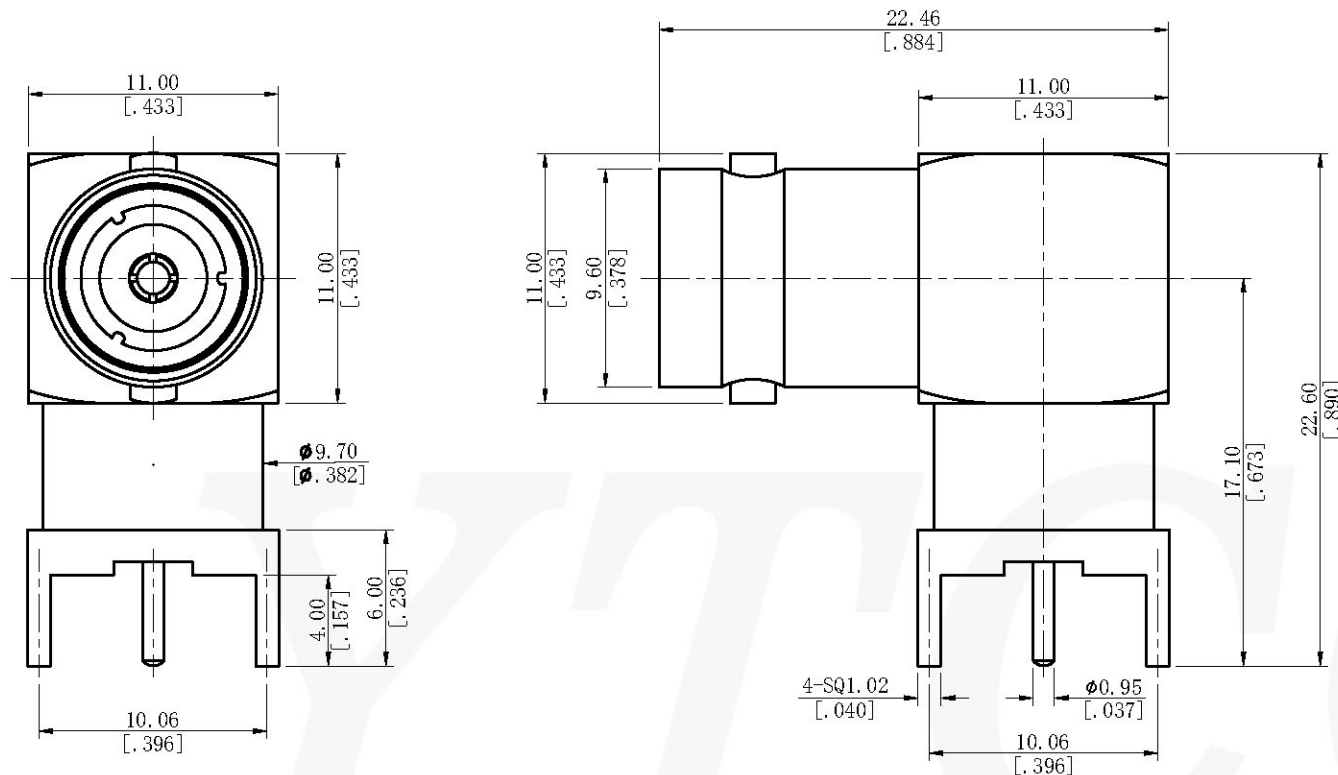

TECHNICAL SPECS:
 VSWR:1.5 Max
 Impedance:50 Ohm
 Frequency Range: 0~3 GHz
 Insulation Resistance:5000 Ohm Min
 Working Voltage:500V RMS at Sea Level
 Dielectric Withstanding Voltage: 1500V RMS
 Center Contact Resistance:1.50 mOhm Max
 Outer Contact Resistance:1.00 mOhm Max
 Operation Temperature:-55°C~+155°C

Material
 Body:Brass, Nickel Plated
 Contact:Brass, Gold Plated
 Insulator:Teflon

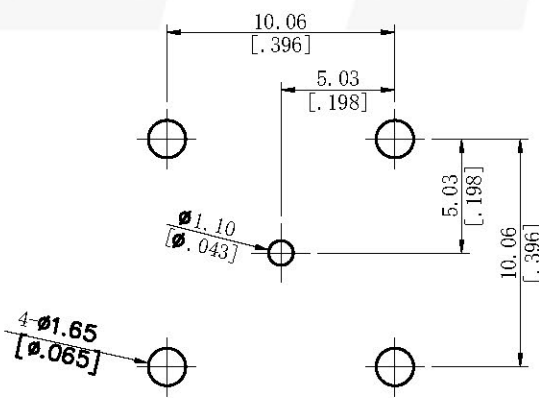

THIS DRAWING IS A CONTROLLED DOCUMENT				 YTCO TECHNOLOGY HTTP://WWW.YTCO.CO E-MAIL:SALES@YTCO.CO	
TOLERANCES UNLESS OTHERWISE SPECIFIED	UNITS mm/inch	SCALE FIT	SIZE A4	TITLE BNC ELBOW PCB SOCKET	
DRAWN BY Xu	DATE 7/30/2022	PART NO. RF01-102S01		FILE PATH A/D/YTCOTZ/RF CONNECTOR/BNC	
ENGINEER Zhang	DATE 7/30/2022	DRAWING NO. RF01		SHEET 1 OF 1	
CHECKED BY Mike	DATE 7/30/2022	REV A		REV	
APPROVED BY Andy	DATE 7/30/2022	PROJ. 594309442		REV	